

# George Washington Hall Murals

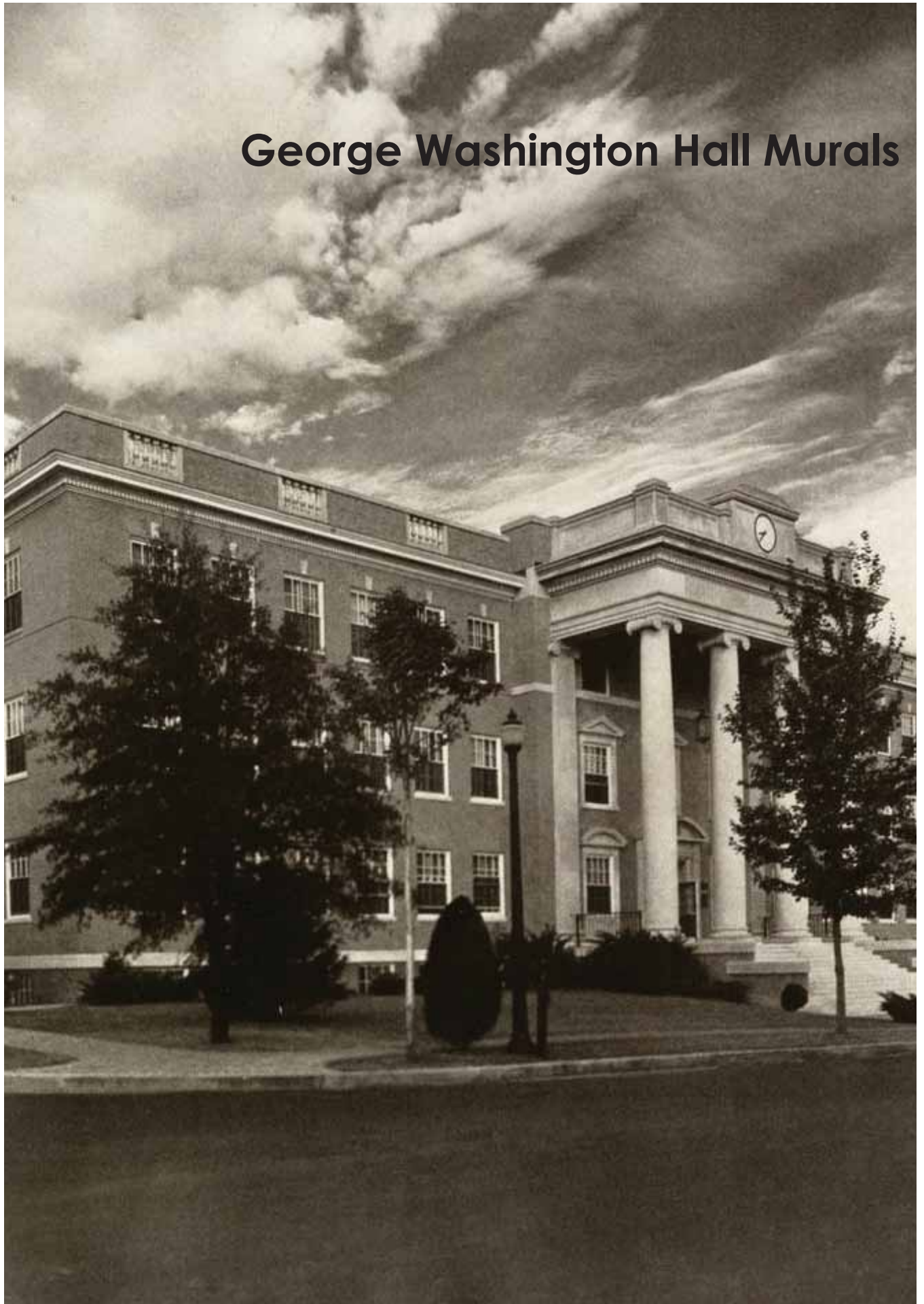

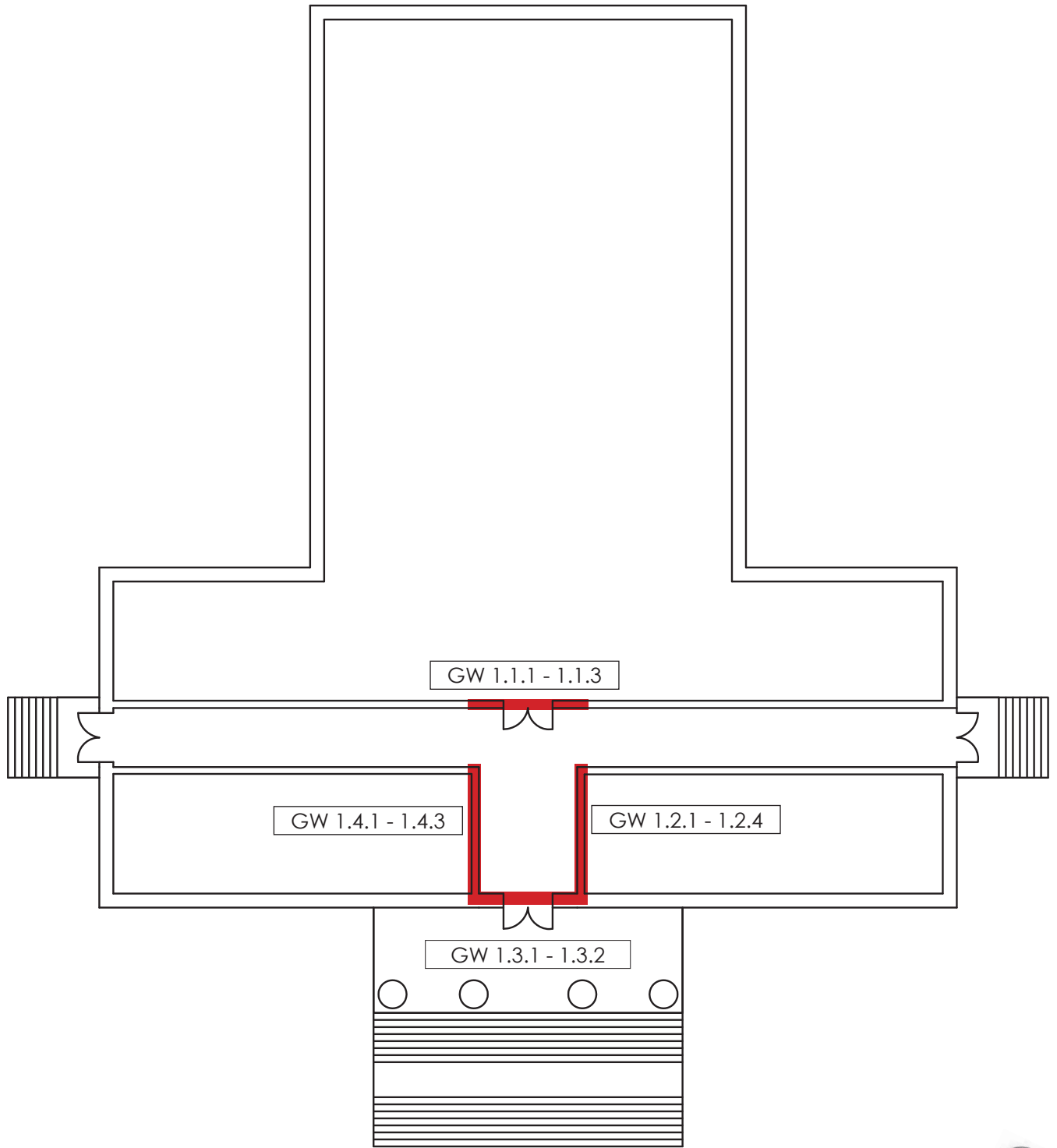



Not to scale      Location of George Washington Hall murals  
1st Floor Plan





**ID Number:** GW 1.1.1

**Subject/Description:**

Inspired by the graduation procession with faculty members. Monroe Hall appears in the background of the procession on the left and Chandler Hall on the right. The colors of the university are draped over a book in the middle.

**Artist:** Emil Schnellock in collaboration with faculty and students

**Date Painted:** 1940-1955

**Medium:** Oil on canvas

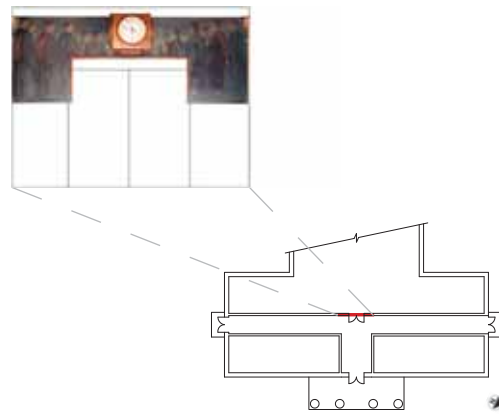



GW 1.1.2



GW 1.1.3

**ID Number:** GW 1.1.2 and GW 1.1.3

**Subject/Description:**

GW 1.1.2 - Inspired by a graduation procession by faculty members with Monroe Hall in the background. The colors of the university are draped over a book.  
 GW 1.1.3 - Inspired by Chandler Hall in the background and faculty members in a graduation procession.

**Artist:** Emil Schnellock in collaboration with faculty and students

**Date Painted:** 1940-1955

**Medium:** Oil on canvas

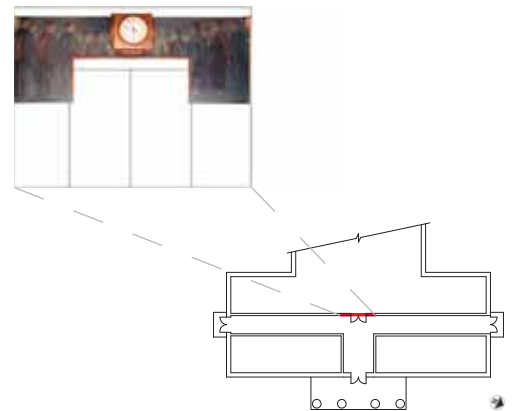



**ID Number:** GW 1.2.1

**Subject/Description:**

Inspired by staff member, Wallace Alsop, custodian of George Washington Hall.

**Artist:** Emil Schnellock in collaboration with faculty and students

**Date Painted:** 1940-1955

**Medium:** Oil on canvas

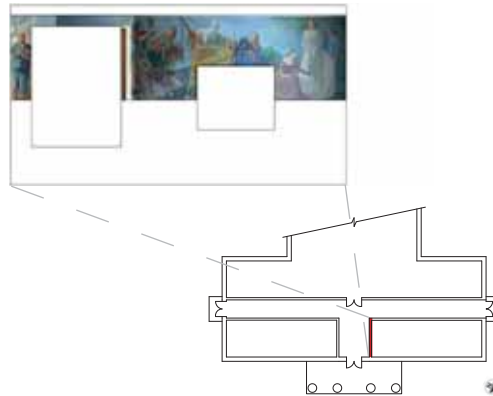



**ID Number:** GW 1.2.2

**Subject/Description:**

Inspired by the Art Department. Seated, Jean Jones Pierson is holding a self-portrait of Julien Binford, professor of art from 1946 to 1971. The other two figures have not been identified.

**Artist:** Emil Schnellock in collaboration with faculty and students

**Date Painted:** 1940-1955

**Medium:** Oil on canvas

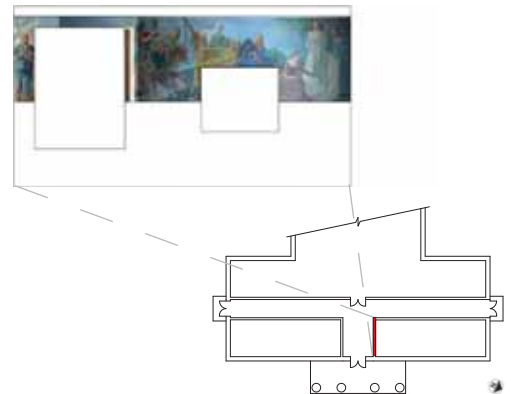



**ID Number:** GW 1.2.3

**Subject/Description:**

Inspired by the Modern Dance Club. Standing in a white Harlequin costume holding a guitar is thought to be Margaret "Peggy" Moran Logan. Leaning with the gold dress is a composite of Lilius Scott Keel and Elsie Scott McDowell. Elsie McDowell also posed for the figure in the blue dress along with Ann Harris Skinner.

**Artist:** Emil Schnellock in collaboration with faculty and students

**Date Painted:** 1940-1955

**Medium:** Oil on canvas

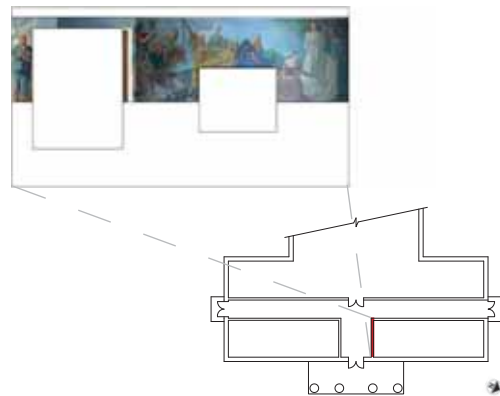



**ID Number:** GW 1.2.4

**Subject/Description:** Inspired by May Day celebrations. Standing between two women is Lois Saunier Hornsby who wore the white dress for the May Day celebration. Mary Will Sheffield, kneeling, and Ellen Alvey Montlier, standing, are adjusting her dress.

**Artist:** Emil Schnellock in collaboration with faculty and students

**Date Painted:** 1940-1950s

**Medium:** Oil on canvas

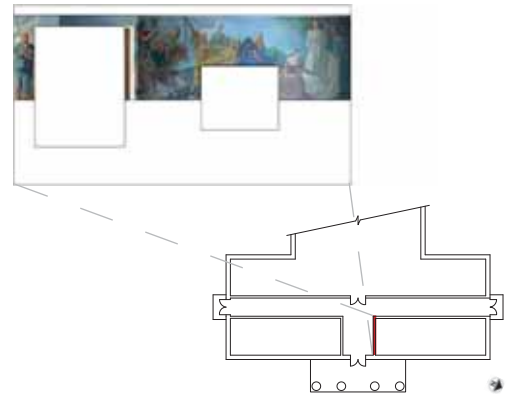



**ID Number:** GW 1.3.1

**Subject/Description:**

Inspired by riders Phyllis A. Nash, member of the Hoofprints Club and Dorothy E. Reisig, member of the Cavalry Troop.

**Artist:** Emil Schnellock in collaboration with faculty and students

**Date Painted:** 1940-1955

**Medium:** Oil on canvas

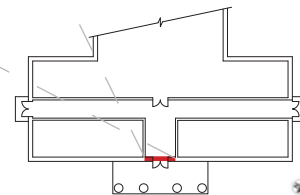



**ID Number:** GW 1.3.2

**Subject/Description:**

Inspired by the Music Department. Drum majorette Doris Ann Lindsey Whitfield and twirler Dawn L. Van Buskirk Derridinger

**Artist:** Emil Schnellock in collaboration with faculty and students

**Date Painted:** 1940-1955

**Medium:** Oil on canvas

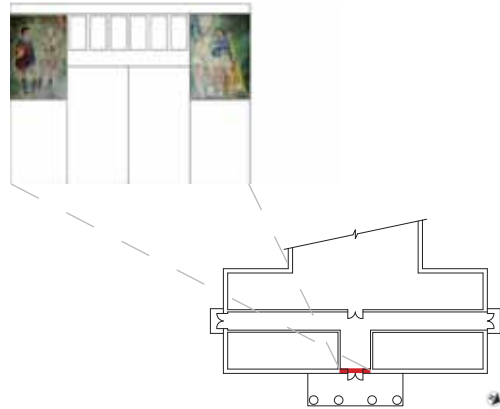



**ID Number:** GW 1.4.1

**Subject/Description:**

Inspired by the Music Department. Faculty member, Ronald Faulker, assistant professor of music and students is leaning over two students, Margaret Ann Jones with the violin and Constance Pusey with the cello. The Communications Department is featured by Virginia Morgan with the microphone. Lillie Truman holding the Virginia flag and unknown student holding the American flag. Frances Lawson is seated by the globe.

**Artist:** Emil Schnellock in collaboration with faculty and students

**Date Painted:** 1940-1955

**Medium:** Oil on canvas

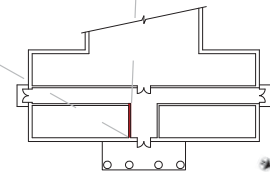



**ID Number:** GW 1.4.2

**Subject/Description:**

Inspired by faculty members, Dr. Morgan Combs, president of the college, and Edward Alvey, Jr., dean of the college presenting diplomas to students. Beverly Roberts identified as the first figure then the subsequent figures are composites of Lucy Dickenson, Juanita Lassiter, Lynne Wilkins, Evelyn Hudson Bunting, and Mary Gladys Lednum. Ball Hall is visible in the background of the graduation ceremony.

**Artist:** Emil Schnellock in collaboration with faculty and students

**Date Painted:** 1940-1955

**Medium:** Oil on canvas

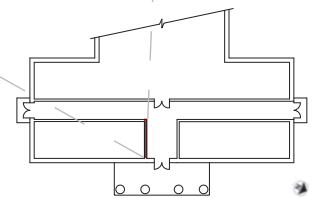



**ID Number:** GW 1.4.3

**Subject/Description:** Inspired by Sarah Lou Miller, representing the English Department. The book below reveals a portrait of Robert E. Lee. Trinkle Hall is visible in the background. The various sciences are represented by Lillie Turman with the test tubes; a composite of Ruth Conover and Ann Martin leaning on the table; Beth Copps who is leaning on the table with the brown hair; and Marjorie Burgess who is performing laboratory work.

**Artist:**

**Date Painted:** 1940-1950s

**Medium:** Oil on canvas

